

CHOIL
조일알미늄



조일알미늄 [주]

HEAD OFFICE & FACTORY

1207-10, Shinsang-Ri, Jinryang-Eup, Kyongsan-City, Kyungbook, Korea

Tel : 82-53-856-5252~5, 82-53-856-5777

Fax : 82-53-856-5257, 82-53-856-5227

<http://www.Choilal.co.kr>

SEOUL OFFICE

8Fl., Yoondang Bldg., 634-10, Shinsa-Dong, Kangnam-Gu, Seoul, Korea

Tel : 82-2-540-3481~8 Fax : 82-2-540-3489

The Affiliated Companies & Schools

Chokwang Co., Ltd.

3Fl., Dae-A Bldg., 212-1 Bumeo-Dong, Soosung-Gu, Daegu, Korea

TEL. (053)751-8096~8 FAX. (053)751-8115

MS Mutual Savings Bank

1-2Fl., Dae-A Bldg., 212-1 Bumeo-Dong, Soosung-Gu, Daegu, Korea

TEL. (053)756-5200 FAX. (053)754-9565

MS Mutual Savings Bank

2-1, Wanjeon-Dong, Joong-Gu, Daegu, Korea

TEL. (053)425-9481 FAX. (053)425-0576

MS Mutual Savings Bank

273-11, Sambok-Dong, Kyongsan-City, Kyungbook, Korea

TEL. (053)811-7311 FAX. (053)815-1531

MS Mutual Savings Bank

48-8, Namsung-Dong, Sangju-City, Kyungbook, Korea

TEL. (054)534-6111 FAX. (054)534-6108

Choyang Development Co., Ltd. / Jeju Marina Tourist Hotel

300-9, Yun-Dong, Jeju, Korea

TEL. (064)746-6161 FAX. (064)746-1670

Sangseo Middle School

645-1, Sungdang-2Dong, Dalseo-Gu, Daegu, Korea

TEL. (053)626-8107~8 FAX. (053)629-3672

Sangseo Girl's Information High School

645-1, Sungdang-2dong, Dalseo-gu, Daegu, Korea

TEL. (053)626-8107~8 FAX. (053)629-3672

Choil Technical High School

50, Shinpyung-Dong, Dong-Gu, Daegu, Korea

TEL. (053)962-6742 FAX. (053)962-6743

Choongok Scholarship Foundation

3Fl., Dae-A Bldg., 212-1, Bumeo-Dong, Soosung-Gu, Daegu, Korea

TEL. (053)751-8096~8 FAX. (053)751-8115

CHOIL

조일알미늄



會長 李 在 燮
Chairman Lee, Jae - Sup

최고의 품질로 고객감동을 실현해 가고 있습니다.

“相互協同, 技術革新, 人力開發”의 社訓을 바탕으로 항상 고객을 먼저 생각하고 열린 마음으로 끊임없는 변화를 추구하며, 항상 최고를 지향하는 기업문화를 만들어 가고 있습니다.

저희 朝日알미늄(주)는, 1945년 設立하여 가정용 기물을 생산해온 朝鮮企業社를 母胎로 하여 60여년의 企業歷史를 자랑하고 있습니다.

국내 알미늄 板材會社로서는 가장 오랜 역사와 최고의 기술력을 가지고 있으며, 국내에서는 유일하게 D.C. 및 C.C. 설비를 同時에 보유하고 있어, 품질의 고급화와 제품의 다양화로 많은 고객들의 신뢰를 받고 있습니다.

뿐만 아니라 1998년 2월 프랑스 Pechiney社에서 도입한 2대의 3CM Caster 와 Siemens社의 DSR Roll이 설치되어 연간 16만톤의 生産능력을 確保함으로써 C.C. 라인 단일 설비로서는 세계 최대규모의 알미늄 板材會社로서의 위치를 다시 한번 더 확고히 다지게 되었습니다.

또한 국내 비철금속 역사를 창출시키면서 폭넓은 기술력과 개발력을 바탕으로 대량 生産능력과 최고수준의 품질을 자랑하는 朝日알미늄은 앞으로도 더욱 지속적인 성장을 유지해 나갈 뿐만 아니라 (주)조광, MS相互貯蓄銀行, 조양개발(주), 제주마리나관광호텔, 상서중학교, 상서여자정보고등학교, 조일공업고등학교, 춘곡장학재단등의 계열로 제조업, 금융업, Service, 교육 등 사회의 다양한 분야에서 국가 경제 발전에 이바지하고 있으며, 기업의 가치를 더욱더 높여 고객과 인류사회에 공헌하는 기업으로 21世紀를 선도해 나갈것입니다.

朝日알미늄株式會社
社長 李 榮 鎬 拜
會長 李 在 燮 拜



프랑스 "레죈 도뇌르" 훈장수상
Awarded FRENCH DECORATION
" LA LEGION D' HONNEUR "

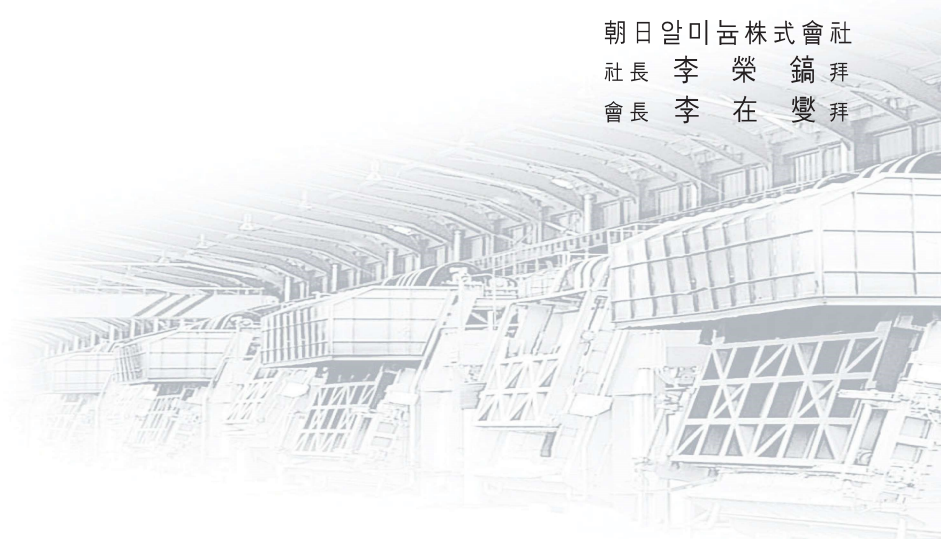

We realize the strong impression to our customers with the highest quality.

We embrace mutual cooperation, technological innovation, and human resources development as our motto. We put our customers first and pursue innovation with clear goals and open minds. We also strive to create a corporate culture geared toward pursuing the top position with passion.

Originating from Chosun Enterprise Co., which was established in 1945 and was engaged in manufacturing household wares, Choil Aluminum Co., Ltd. boasts 60 years of corporate history.

We have the longest history and the top technology of Korea's aluminum ware makers. We are also the first and only company to be equipped with both D.C. Line and C.C. Line equipment and facilities, and have won many customers' confidence in our diverse and premium products.

Moreover, we operate 2 sets of 3CM Caster introduced from France's Pechiney in February 1998, as well as 1 set of DSR Roll introduced from Siemens, and thus we are capable of producing 160,000 tons yearly. This makes our C.C. Line in aluminum ware production become the world's largest capacity.

In addition, we started Korea's history of non-ferrous metals, and have secured an array of technologies and development abilities, as well as mass production abilities to produce top quality products.

We are determined to further grow. Also, our affiliates include Chokwang Co., Ltd., MS Mutual Savings Bank, Choyang Development Co., Ltd., Jeju Marina Tourist Hotel, Sangseo Middle School, Sangseo Girl's Information High School, Choil Technical High School, and Chungok Scholarship Foundation. These are engaged in various areas such as manufacturing, financial service, tourism service, and education. We strive to further enhance our corporate value and contribute to customers and the public.



社長 李 榮 鎬
President Lee, Young - Ho

CHOIL Aluminum Co., Ltd.
President Lee, Young - Ho
Chairman Lee, Jae - Sup

Global시대 조일알미늄이 세계속의 초일류기업으로 힘차게 도약합니다.

In the Global age, Choil Aluminum Co., Ltd. powerfully leaps to the highest class enterprise in the world.



● 역사 관 / Historical View

- 1934. 04. 환산전기 백화점 설립
- 1945. 09. 조선기업사 설립(전기자재 수입 판매업)
- 1960. 01. 조선기업사 알미늄 제품 가정용 기물 생산 개시
- 1974. 11. 朝日알미늄 설립
- 1975. 02. D.C. Line 설치 완료 및 제품 생산 개시(폭 600mm)
- 1979. 10. 1호 Caster(Jumbo 3C) 및 1호 냉간 압연기 설치완료
- 1979. 11. C.C. Line 설치 완료 및 제품 생산 개시(폭 1,350mm)
- 1985. 07. 법인으로 전환 → 朝日알미늄 공업(株)
- 1988. 11. 기업공개
- 1990. 07. 3호 냉간 압연기 설치 완료(폭 1,100mm)
- 1994. 06. 진량공단부지 입주 계약 완료
- 1996. 01. 진량공장 건축공사 기공
- 1997. 06. 7, 8, 9호 Jumbo 3C Caster 3기 설치 완료(폭 1,750mm)
- 1997. 08. 10, 11호 Jumbo 3CM Caster 2기 설치 완료 및 제품 생산 개시
- 1997. 10. 재단기 2기 설치 완료(Combination 및 Slitting Lines)
- 1997. 11. 이재섭 회장 프랑스 “레종 도뇌르” 훈장 수상
- 1997. 12. 5호 냉간 압연기 설치 완료 및 제품 생산 개시(폭 1,750mm)
- 1998. 02. 진량공장 설비 완료
- 1999. 07. ISO 9002 인증
- 2003. 03. 납세자의날 산업포장 수상
- 2004. 03. 대표이사 사장 이영호 취임
- 2004. 12. 대구공장 이전완료
- 2005. 10. 기술연구소 준공
- 2006. 08. 12호 Caster 설치완료
- 2007. 06. ISO 14001 환경 KOHSMS 18001 안전보건 인증 획득





- Apr. 1934 Established Hwansan Electric Department Store.
- Sep. 1945 Established Chosun Enterprise Co.
(Importer & seller in domestic market of electric materials)
- Jan. 1960 Chosun Enterprise Co. started to manufacture
the aluminum homeware products.
- Nov. 1974 Established CHOIL Aluminum Co.
- Feb. 1975 Finished establishment of D.C. Line and started to manufacture
the aluminum products in 600mm width.(No.2,3 Cold Rolling Mill)
- Oct. 1979 Finished establishment of No.1 Caster(Jumbo 3C) &
No.1 Cold Rolling Mill.
- Nov. 1979 Started to manufacture C.C. products in 1,350mm width.
- Jul. 1985 Reorganized as a joint - stock company, under same leadership.
- Nov. 1988 Become a Joint - Stock Certificated company.
- Jul. 1990 Finished establishment of No.3 Cold Rolling Mill in 1,100mm width.
- Jun. 1994 Prepared the new place for the new factory.
- Jan. 1996 Started the foundation for the new factory' s buildings.
- Jun. 1997 Finished establishment of three Jumbo 3C Casters.
- Aug. 1997 Finished establishment of two Jumbo 3CM Casters.
- Oct. 1997 Established two Finishing Lines(Combination and Slitting Lines)
- Nov. 1997 President Mr. LEE was awarded FRENCH DECORATION
"LA LEGION D' HONNEUR"
- Dec. 1997 Finished establishment of No.5 Cold Rolling Mill in 1,750mm Width.
- Feb. 1998 Finished establishment of all equipments for the new factory.
- Jul. 1999 Acquired Certificate ISO 9002.
- Mar. 2003 Won the Prize of Industry on the Day of Taxpayer.
- Mar. 2004 Appointed the president, Lee, Young-Ho
- Dec. 2004 Finished the move of Daegu factory.
- Oct. 2005 Completed the Technical Research Institute.
- Aug. 2006 #12 Caster completed.
- Jun. 2007 Acquisition of ISO 14001 KOHSMS 18001.

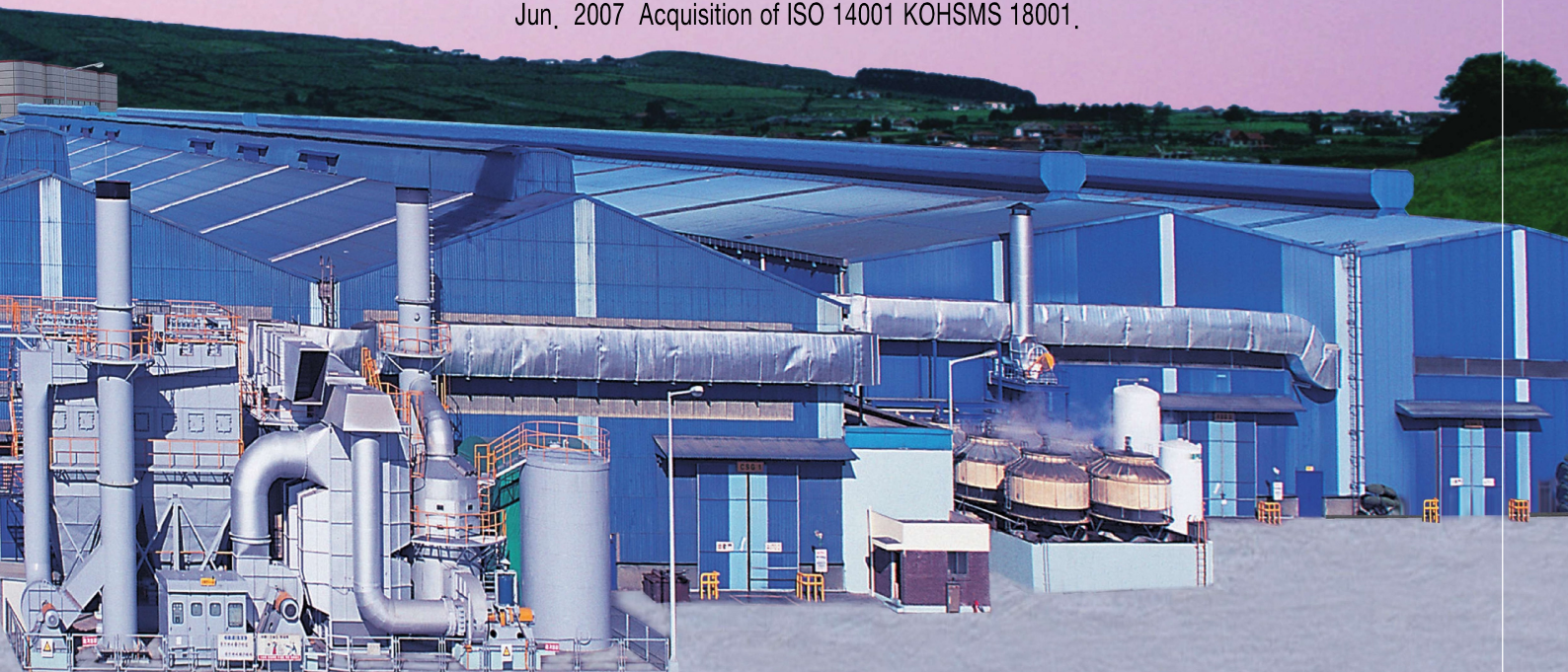



C.C. LINE

- 용해로 / Melting Furnace (35Ton/Charge 10Sets)
- 보조로 / Holding Furnace (30Ton/Charge 10Sets)
- 주조기 / Jumbo 3C Caster (Max. Width : 1,350mm 2Sets, 1,750mm 6Sets),
3CM Caster (Max. Width : 1,500mm 2Sets)
- 냉간압연기 / Cold Rolling Mill (Max.Width:1,350mm1Set,1,750mm 2Sets, 1,100mm 1Set)
- 재단기 / Rewinder (Max. Width : 1,350mm 1Set, 1,700mm 2Sets)
Combination Line with Embosser (Max. Width : 1,750mm 1Set) · Combination Line
(Max. Width : 1,350mm 1Set) Cut-to-Length (Max. Width : 1,500mm 1Set)
Scroll Shear (Max. Width : 1,016mm 1Set, 1,250mm 1Set)
Tension Leveller (Max. Width : 1,575mm 1Set, 1,350mm 1Set)
Washing Line (Max. Speed : 150m/min 2Sets) · Stretcher (4' × 4,000 l 1Set)
- 소둔로 / Annealing Furnace (25Ton/Charge 4Sets, 60Ton/Charge 8Sets, 40Ton/Charge 4Sets)
- 연마기 / Roll Grinder (Swing : 1,140mm 2Sets, 600mm 1Set)

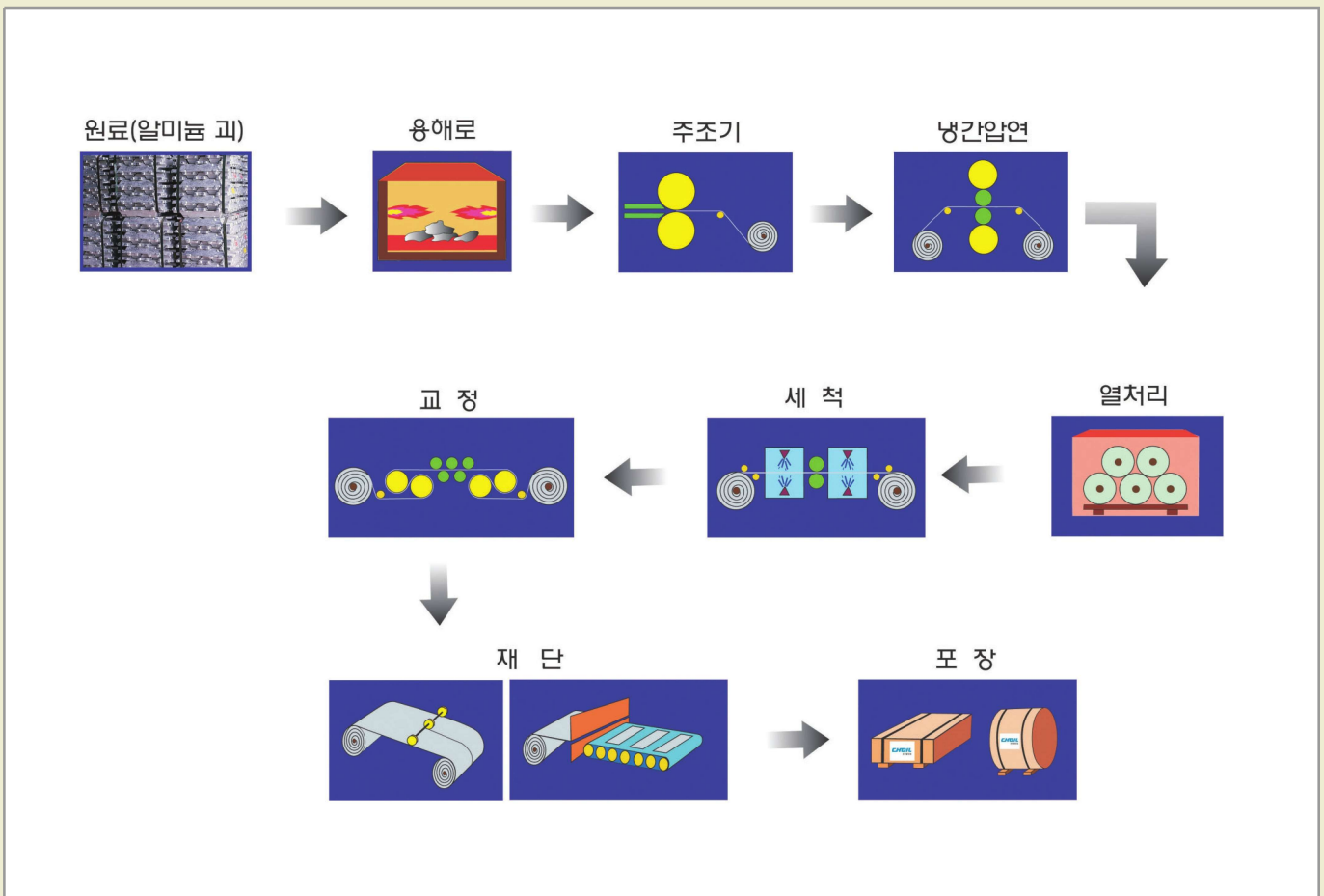



D.C. LINE

- 용해로 / Melting Furnace (30Ton/Charge 2Sets)
- 주조기 / Slab Caster (Width : 350~700mm 1Set)
- 면삭기 / Scalping Machine (2Sets)
- 열간압연기 / Hot Rolling Mill (1Set)
- 냉간압연기 / Cold Rolling Mill (3Sets)
- 수동압연기 / Pull Over (1Set)
- 재단기 / Rotary Shear, Slitter, Automatic Shear, Cut-to-Length
- 소둔로 / Annealing Furnace (Capacity : 12Ton, 25Ton)

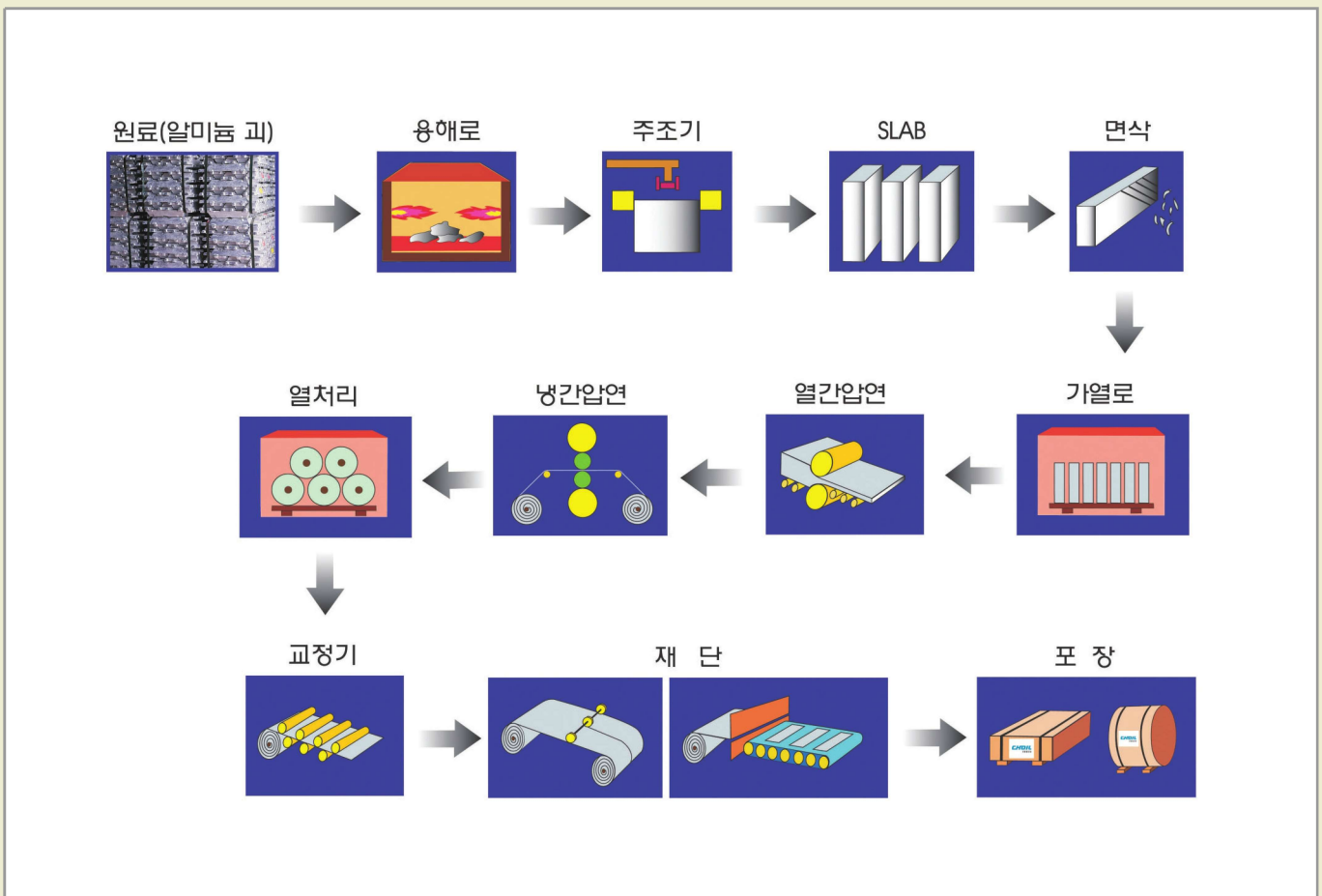

조일알미늄은 단합된 도전정신으로 밝은미래를 준비하고 있습니다.

Choil Aluminum Co., Ltd. prepares for the bright future with the united challenge spirit.

조일알미늄은 치열한 경쟁속에서도 끊임없는 기술개발과 차별화된 인재양성으로 글로벌시대에 경쟁력을 높여가고 있습니다. 또한 고객만족을 위한 평가시스템을 운영하여 일류품질, 일류기업으로 발돋움하기 위해 인재중심의 기술혁신을 통한 가치를 창출하고 있습니다.

Choil Aluminum Co., Ltd. increases its competitive power in the Global age with constant technical development and distinctive training of capable men even in violent competition. In addition, it creates the value through the talent-centered technical renovation to overstretch itself as first-class quality and first-class enterprise by operating the Appraisal System for its customers' satisfaction.





21C Vision

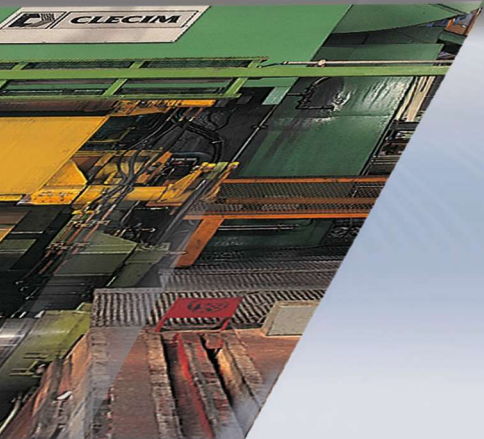

용해주조 | Melting & Casting

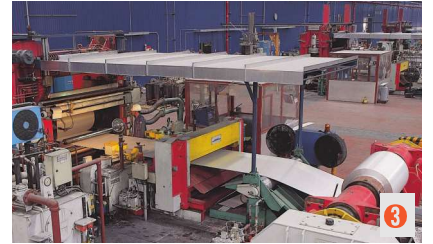
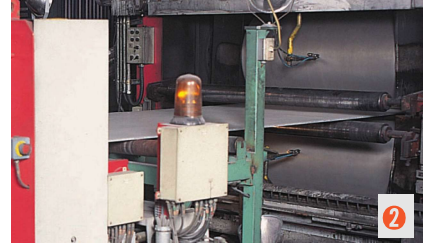

- ① 용해로 (시 용해 공장)
- ② Strip 연속 주조 과정
- ③ 연속주조기 (3C Caster, 최대폭 : 1,350mm 3대, 1,750mm 6대)
- ④ 용해로 (35Ton/Charge), 보조로 (30Ton/Charge) 전경
- ⑤ 연속주조기 (3CM Caster, 최대폭 : 1,500mm 2대)

단일 공장 세계최대의 시 연속주조설비로서 3C & 3CM Caster 및 고품질의 제품을 생산하기 위한 연료조절장치, 전자교반장치를 운용하며, 효율적인 Filter System과 탈가스 처리를 통해 Metal의 청정화를 도모하는 공정입니다. 특히 최근에 개발된 3CM Caster는 금속조직 측면에서 보다 우수한 품질의 제품을 생산하고 있습니다.

As the largest continuous roll casting plant in the world, our plant has 3C & 3CM Casters, the furnaces with sophisticated air / fuel ratio controlling system, electro-magnetic stirrer, and the effective filtering & degassing system which can sufficiently control the metal remain in high quality. Especially, the newly-developed 3CM Caster enables us to supply the metallurgically excellent products to our customers.





냉간압연 Cold Rolling

연마·소둔 Roll Grinding & Annealing

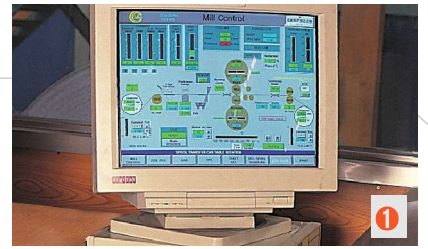

10
1

냉간압연기 / Cold Rolling Mill

AGC(Automatic Gauge Control) 및 AFC(Automatic Flatness Control) System을 갖춘 4대의 냉간압연기로 두께 및 형상을 제어하고, 특히 5호 압연기에 DSR(Dynamic Shape Roll)을 설치하여 고정밀도로 형상을 제어하며 0.15mm에서 10mm까지 압연하는 공정입니다.

The 4sets of cold rolling mills equipped with AGC(Automatic Gauge Control) and AFC(Automatic Flatness Control), are able to adjust and control the flatness and the thickness of strip automatically and accurately. Especially, No. 5 Mill with DSR(Dynamic Shape Roll) is capable to control the flatness in high level to satisfy our customers' various demands and meet the requirement of the gauge from 0.15mm to 10mm.

- ① AFC 시스템
- ② 냉간압연 탈지기
- ③ 연마기 (Swing : 1,140mm 2대, 600mm 1대)
- ④ 냉간압연기 (최대폭 : 1,750mm 2대, 1,350mm 1대, 1,100mm 1대)
- ⑤ 소둔로 (60Ton/Charge 9대, 25Ton/Charge 7대, 40Ton/Charge 2대)

- ① AFC System
- ② Cold Rolling Mill Degreasing Line
- ③ Grinding Machine (Swing : 1,140mm 2Sets, 600mm 1Set)
- ④ Cold Rolling Mill (Max. Width : 1,750mm 2Sets, 1,350mm 1Set, 1,100mm 1Set)
- ⑤ Annealing Furnace (60Ton/Charge 9Sets, 25Ton/Charge 7Sets, 40Ton/Charge 2Sets)

소둔로 / Annealing Furnace

열처리 공정은 금속학적으로 재료의 물성 조절과 품질 개선에 중요한 역할을 하고, 균질화처리, 중간소둔처리, 최종소둔처리 등 적절한 열처리를 통하여 우수한 품질의 제품을 생산합니다.

The heat treatment process plays an important role in adjusting the temper and improving the quality of the material metallurgically. The proper heat treatment by homogenization, inter-annealing and final annealing enables us to produce high quality products.



4



5

재 단 | Finishing



- ① 세척기 / Washer
- ② 교정기 / Tension Leveller
(Max. Width: 1,575mm 1Set, 1,350mm 1Set)
- ③ Rewinder
(Max. Width: 1,680mm, Mini 700mm)
- ④ Combination Line with Embosser (Max. Width : 1,750mm 1Set)
Combination Line (Max. Width : 1,350mm 1Set)
- ⑤ Scroll Shear
Strip Width Range (Max. 1,250mm, Mini. 609,6mm)

각종 재단 설비와 우수한 기술로, 고정밀도의 치수 정확성 및 우수한 표면 품질을 갖춘, Coiled sheet, Sheet & Plate, Circled Sheet 등 다양한 형태의 제품을 생산하는 공정입니다.

With the various finishing machines and accumulated operating skills, this process can supply the most precise and clean coiled sheet, sheet and plate, circled sheet to the customers.





D.C. LINE



- ① 균열로 / Pusher Furnace
- ② 열간압연기(동력 : 1,000HP)
Hot Rolling Mill (Main Motor Power : 1,000HP)
- ③ 열간압연라인 / Hot Rolling Mill Line
- ④ 주조기 / Direct Chill Caster
- ⑤ 냉간압연기(최대폭 : 600mm, 3대)
Cold Rolling Mill (Max. Width : 600mm, 3Sets)

국내 최초의 Al. 압연설비로, D.C. Caster, 열간 및 냉간압연기와 다양한 재단설비를 보유하여, 화장품 Cap, 전기·전자부품, 명판, 주방용품등을 고객의 요구에 맞게 다양한 규격과 고품질로 생산합니다.

As the first Aluminum rolling facility in Korea, we have Direct Chilling Caster, hot/cold rolling mills and various finishing machines which enable us to meet the requirement of high quality and various size by customers in cosmetic caps, electrical-electronic parts, name plates and household goods, etc.



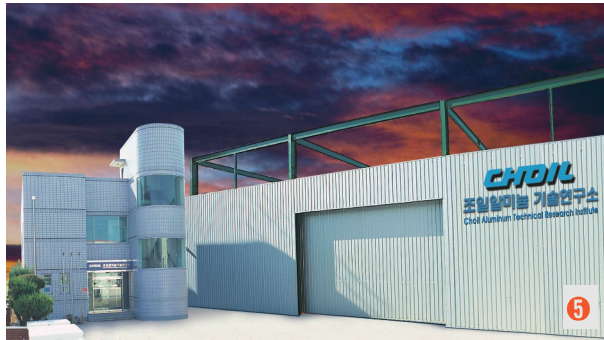

최첨단 장비와 우수한 인재들로 이루어진 기술연구소는 신제품 개발과 품질개선을 위해 최선을 다하고 있습니다.

We do our best for the developments of new products and improvement of quality through our Technical Research Institute which consists of the most advanced equipment and excellent capable men.

21C 세계 AI 산업을 이끌어 갈 조일알루미늄은 최신 제조설비를 바탕으로, 고품질의 제품을 생산하기 위해 노력하고 있으며, 각종 시험·분석장비로 첨단소재, 신소재등의 연구·개발에도 최선을 다하고 있습니다.

특히 C.C (Continuous Casting)공법으로 주조된 제품의 품질 극대화 및 특성화를 위하여, 축적된 기술과 경험으로 경쟁력있는 우수한 제품개발에 모든 역량을 기울이고 있습니다.

On the basis of ultra-modern facilities, Choiil Aluminum who will lead the aluminum industry in the 21st century, is trying to produce high quality products, and doing his best to research and developing the advanced new material with various tests and analysis units.

Especially, to maximize the quality of C.C (Continuous Casting) products manufactured by the continuous casting method and enhance the specialization of this technology, Choiil is striving to research the quality advancement through its accumulated technology and experience.





1



2



3



4

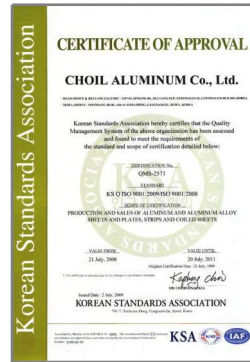
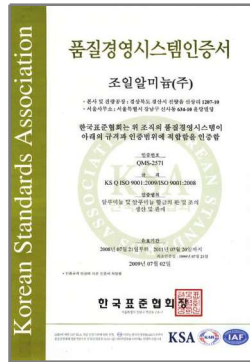
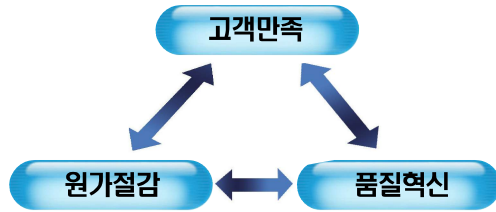

● KS Q ISO 9001:2009 품질경영시스템 인증
KS Q ISO 9001:2009 / ISO 9001:2008
Certification of Quality Management System.

● KS Q ISO 9001:2009 품질경영시스템 인증
KS Q ISO 9001:2009 / ISO 9001:2008
Certification of Quality Management System.

- 1 만능재료시험기 / Universal Testing Machine
- 2 발광분광 분석기 / Emission Spectrometer
- 3 광학 현미경 / Optical Microscope
- 4 화학실험 / Chemical Test
- 5 기술연구소 / Technical Research Institute
- 6 물성시험실 / Mechanical Lab.
- 7 세미나실 / Seminar Room

14
15



6



7

알루미늄은 무한한 활용성으로 다양한 분야에서 활용되고 있습니다.

Aluminum is being utilized in various fields by its unlimited application.

■ 알루미늄의 특성 / Property of Aluminum

- ① 열전도성 및 전기전도성 우수
(High Thermal & Electrical Conductivity)
- ② 우수한 성형성 및 내식성
(Excellent Workability & Corrosion Resistance)
- ③ 높은 반사율
(High Reflectivity)

■ 생산품목 / Kinds of Products

Foil Stock, Fin Stock, Condenser Case, Name Plate, Closure Sheet, Cosmetic Cap, Litho Sheet, Car, Household Goods, Electrical Wire Cover, Insulator Covering Material, Mold Transformer, Sound Proofing Wall, Electrical & Electronic Part, Exterior & Interior Construction, Bus Bar, Embossed Sheet, Others.

건축 내·외장재

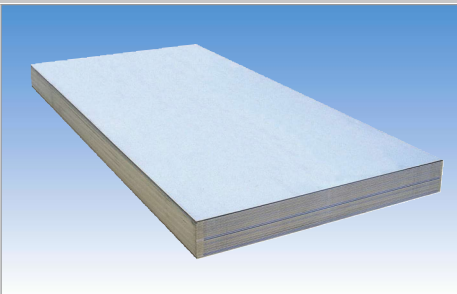

Embossed Sheet

Type : Stucco & Pebble Type
Thickness : 0.5 ~ 3.0mm
Max. Width : 1,700mm

- 특징 : 내구성이 높아 유지관리가 용이하다.
- 용도 : • 건축 내·외장재 / Exterior & Interior decoration for Construction

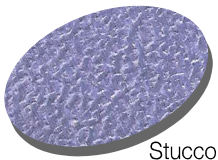

Stucco

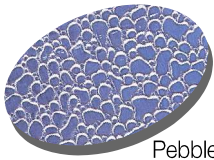

Pebble



제주 컨벤션센터
Jeju Convention Center



삼성 타워팰리스
Samsung Tower Palace

인쇄판 · 방음벽재

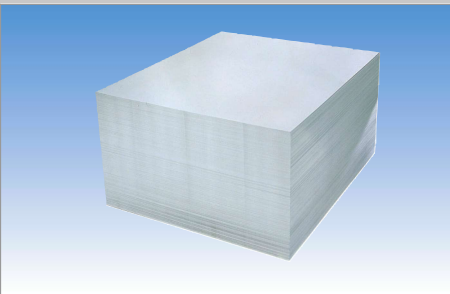

Sheet & Plate

Thickness : 0.2 ~ 200mm
Max. Width : 1,700mm
Max. Length : 4,000mm

- 특징 : 표면처리가 용이하며, 비자성체로 자장에 영향을 받지 않는다.
- 용도 : • 인쇄판 / Litho Sheet
• P.P. Cap / Closure Sheet
• 명판 / Name Plate
• 방음벽재 / Sound Proofing Wall

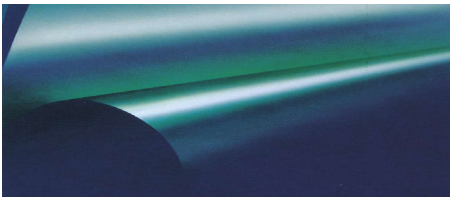

인쇄판
Litho Sheet



방음벽재
Sound Proofing Wall

주방용품 · 조명기구



Circled Sheet

Thickness : 0.4 ~ 3.2mm
Diameter : 200mm ~ 600mm

- 특징 : 각종 형태로 가공이 가능하며, 무해 무취하여 위생적이다.
- 용도 : • 주방용품 / Household Goods
• 조명기구 / Reflector for Light



주방용품
Household Goods



조명기구
Reflector for Light

화장품 Cap · 전자부품

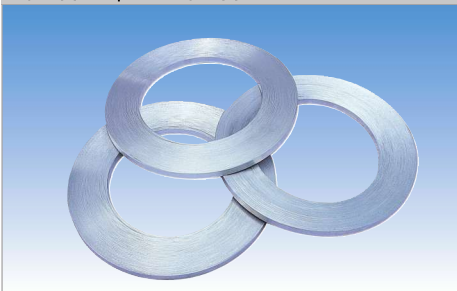

Band

Min. Thickness : 0.15mm
Min. Width : 10mm

- 특징 : 열전도도 및 전기전도도가 높으며, 표면이 깔끔하여 다양하게 활용된다.
- 용도 : • 화장품 Cap / Cosmetic Cap
• 전기, 전자부품 / Electrical & Electronic Part



전자부품
Electronic Part



화장품 Cap
Cosmetic Cap

전선피복 · 보온재

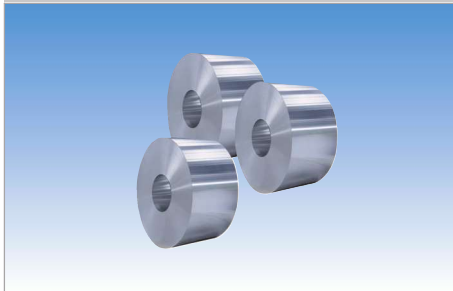

Coiled Sheet

Thickness : 0.2 ~ 4.0mm
Max. Width : 1,700mm
Max. Weight : 9,000Kg

- 특징 : 자연적으로 부식을 방지하며, 빛과열을 반사하여 보온효과가 우수하다.
- 용도 : • Condenser Case
• Mold Transformer
• 전선피복재 / Electric Wire Cover
• 보온재 / Insulator Covering Materials



보온재
Insulator Covering Materials

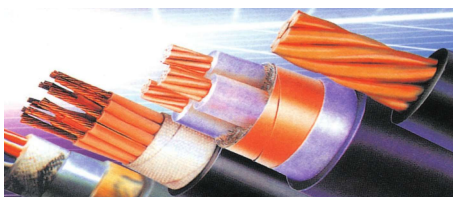

광케이블
Semiconductor

자동차용 · 생활용품

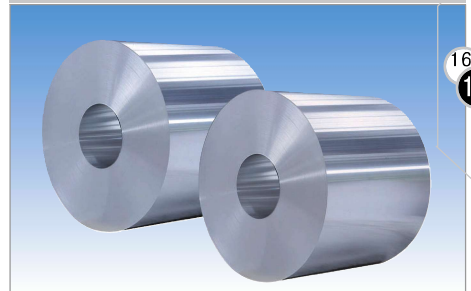

Coiled Sheet

Thickness : 0.2 ~ 2.0mm
Max. Width : 1,700mm
Max. Weight : 9,000Kg

- 특징 : 철의 1/3 비중으로 가볍고 강하며, 재생이 용이하다.
- 용도 : • Foil Stock
• Fin Stock



호일
Foil

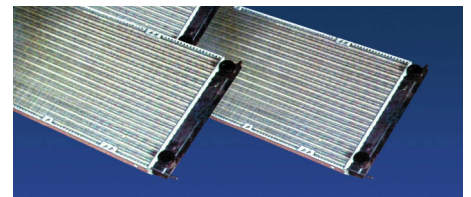

라디에타
Radiator

환경친화 Environmental Facilities

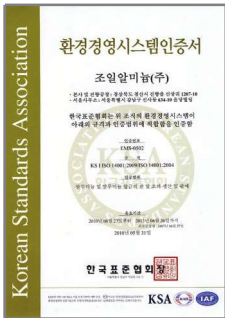

● KSA ISO 14001:2009 환경경영시스템 인증
 KSA ISO 14001:2009 / ISO 14001:2004
 Certification of Environmental Management System.

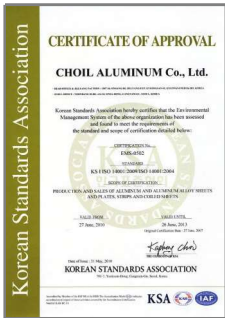

● KSA ISO 14001:2009 환경경영시스템 인증
 KSA ISO 14001:2009 / ISO 14001:2004
 Certification of Environmental Management System.

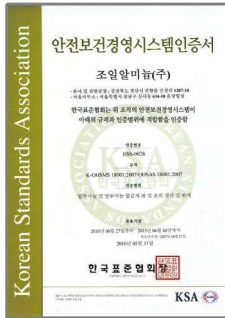

● K-OHSMS 18001:2007 안전보건경영시스템 인증
 K-OHSMS 18001:2007 / OHSAS 18001:2007
 Certification of Health & Safety Management System.

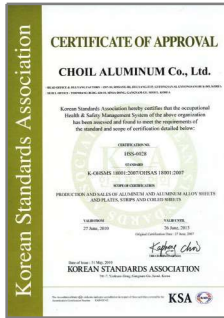

● K-OHSMS 18001:2007 안전보건경영시스템 인증
 K-OHSMS 18001:2007 / OHSAS 18001:2007
 Certification of Health & Safety Management System.



● 환경설비 / Environment Plant

자연과 함께 더불어 살아가는 앞선 기업문화 창출로 다음세대에 귀감이 되는 기업으로 성장 하겠습니다.

We will set an example for our next generation by generation the leading culture of enterprise living together with nature.

■ 환경경영

친환경 제품사용 실천과 오염방지 시스템을 구축하여 오염물질 배출을 최소화 하고 있습니다.

■ 자원 재활용

폐기를 발생을 최소화 하고 알미늄을 재활용하며, 환경친화 제품으로 재탄생 되도록 자원 재활용운동을 지속적으로 펼치고 있습니다.

■ 환경기준 강화

세계적인 환경기준 도입으로 인간과 자연의 공존을 위해 조일알미늄은 다음세대를 생각하고 있습니다.

■ Environmental management

We minimize the discharge of pollutants by practicing use of green products and constructing pollution-preventing system.

■ Resource-recycling

We hold continuously the resource-recycling campaign by minimizing occurrence of wastes, recycling aluminium, and making them be born again as green products.

■ Strengthening of Environmental Standard

Choil Aluminum Co., Ltd. thinks of the next generation for coexistence of human and nature by introduction of systematical environmental standard.





사원복지 | Welfare Facilities

가정의 행복과 소중한 우리모두를 위해 당당하게 최선을 다하는 당신이 자랑스럽습니다.

We are proud of you who do your best for the happiness of your home and all of us.

■ 열린 대화의 장

주1회 임직원이 사원과 함께 희로애락을 공유하는 장으로서 서로의 고충과 격려를 건의를 통해 해결 방안을 모색해 나가고 있습니다.

■ 근로복지기금 운영

조일알미늄 가족들을 위한 복지기금운영으로 어려움을 극복하고 즐거움을 함께 나누는 사원복지 활동을 하고 있습니다.

■ 장학사업

다양한 장학사업을 통하여 창의적인 인재양성에 지원을 아끼지 않고 있습니다.

■ Open window of conversation

Once a week, officers grope for the plan of solution by suggesting mutual troubles and encouragement, sharing the feelings of joy, anger, sorrow and pleasure with their employees.

■ Operating the Labor Welfare Fund

We have a employee-welfare policy for employees families to overcome difficulties and share pleasures of them by operating the welfare fund.

■ Operation of Scholarship Fund

We fully support and train the creative and capable men through various operations of scholarship funds.



- ① 창사 30주년 기념식 / Ceremony of the 30th Anniversary
- ② 축구 회 / Football Association of like-minded persons
- ③ 야구 회 / Baseball Association of like-minded persons
- ④ 볼링 회 / Bowling Association of like-minded persons
- ⑤ 테니스회 / Tennis Association of like-minded persons
- ⑥ 산악 회 / Alpine Association of like-minded persons
- ⑦ 사무환경 / Office Environment
- ⑧ 복지시설 / Welfare Facilities

18
19



7

8